

PLANTA BAJA

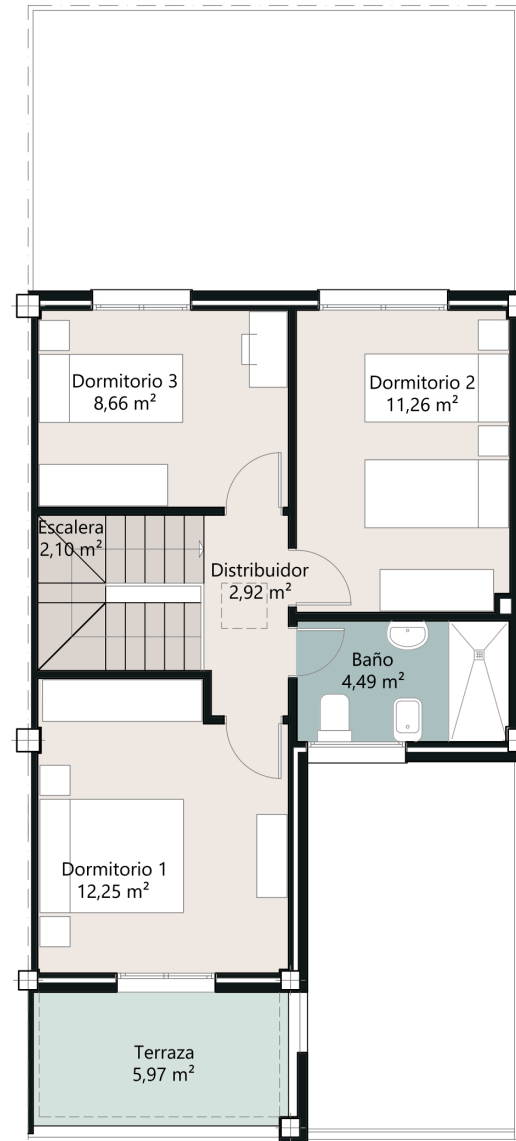

PLANTA PRIMERA

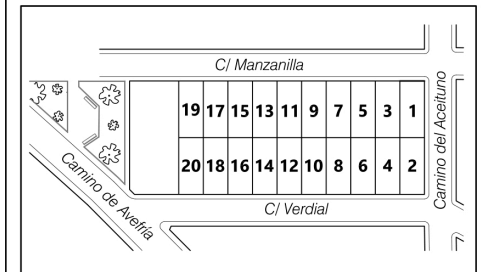

Residencial Cristo Rey, Lebrija

Casas nº 3, 6, 7, 10, 15 y 18

3 Dormitorios

Superficie Terreno 97,50 m² (6,50 x 15,00 m)

Superficies Útiles:

| | Vivienda | Porche y lavadero |
|----|----------------------|---------------------|
| PB | 40,01 m ² | 5,95 m ² |
| P1 | 41,68 m ² | |

Total 81,69 m² 5,95 m²

| | |
|-----------------|----------------------|
| Patio delantero | 13,66 m ² |
| Patio trasero | 27,58 m ² |
| Terraza | 5,97 m ² |

Superficies Construidas:

| | Vivienda | Porche y lavadero |
|----|----------------------|---------------------|
| PB | 48,22 m ² | 6,24 m ² |
| P1 | 51,70 m ² | |

Total 99,92 m² 6,24 m²

| | |
|-----------------|----------------------|
| Patio delantero | 14,37 m ² |
| Patio trasero | 28,66 m ² |
| Terraza | 7,46 m ² |

Almanzora Valle Hoteles S.L.

Tlf. 687 850 922

