

PLANTA BAJA

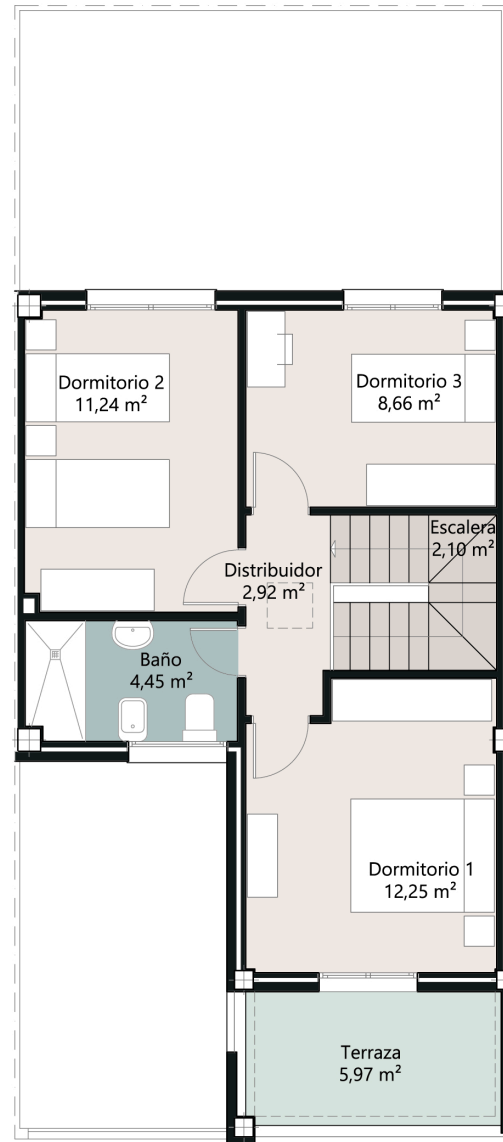

PLANTA PRIMERA

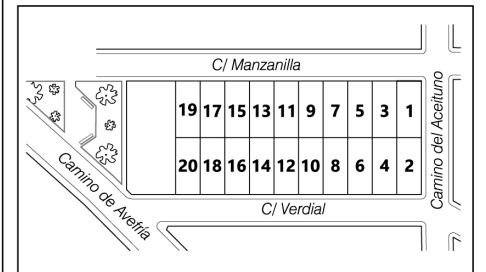

Residencial Cristo Rey, Lebrija

Casas nº 12 y 13

3 Dormitorios

Superficie Terreno 97,50 m² (6,50 x 15,00 m)

Superficies Útiles:

| | Vivienda | Porche y lavadero |
|----|----------------------|---------------------|
| PB | 40,01 m ² | 5,77 m ² |
| P1 | 41,62 m ² | |

Total 81,63 m² 5,77 m²

| | |
|-----------------|----------------------|
| Patio delantero | 13,66 m ² |
| Patio trasero | 27,53 m ² |
| Terraza | 5,97 m ² |

Superficies Construidas:

| | Vivienda | Porche y lavadero |
|----|----------------------|---------------------|
| PB | 48,22 m ² | 6,24 m ² |
| P1 | 51,70 m ² | |

Total 99,92 m² 6,24 m²

| | |
|-----------------|----------------------|
| Patio delantero | 14,37 m ² |
| Patio trasero | 28,66 m ² |
| Terraza | 7,46 m ² |

Almanzora Valle Hoteles S.L.

Tlf. 687 850 922

Escala 1:100